

VIS

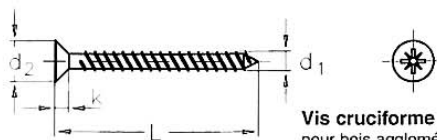

Vis cruciforme INOX
pour bois aggloméré

NIRO Cross recessed chipboard screw

| Désignation nominal size | d ₁ mm | d ₂ mm | L mm | k mm | N° article stock no. |
|-----------------------------|----------------------|----------------------|---------|---------|-------------------------|
| 3 x 25 | 3 | 6 | 25 | 1,9 | 303 010 325 |
| 4 x 40 | 4 | 8 | 40 | 2,5 | 303 010 440 |
| 5 x 50 | 5 | 10 | 50 | 3,0 | 303 010 550 |
| 6 x 60 | 6 | 12 | 60 | 3,6 | 303 010 660 |

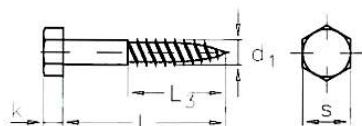

Vis six pans à bois INOX, DIN 571

NIRO Hexagon wood screw acc. to DIN 571

| Désignation nominal size | d ₁ mm | L mm | L ₃ mm | s mm | k mm | N° article stock no. |
|-----------------------------|----------------------|---------|----------------------|---------|---------|-------------------------|
| 5 x 30 | 5 | 30 | 18 | 8 | 3,5 | 303 011 530 |
| 6 x 40 | 6 | 40 | 24 | 10 | 4,0 | 303 011 640 |
| 6 x 70 | 6 | 70 | 42 | 10 | 4,0 | 303 011 670 |
| 8 x 80 | 8 | 80 | 48 | 13 | 5,5 | 303 011 880 |

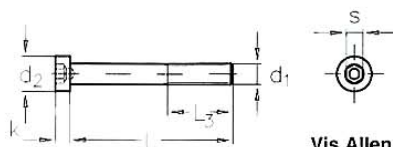

Vis Allen tête basse INOX, DIN 6912
filetage à droite

**NIRO Cylindrical screw with hexagon
socket head acc. to DIN 6912, right hand thread**

| Désignation nominal size | d ₁ | d ₂ mm | L mm | L ₃ mm | k mm | s mm | N° article stock no. |
|-----------------------------|----------------|----------------------|---------|----------------------|---------|---------|-------------------------|
| M 4 x 12 | M 4 | 7,0 | 12 | - | 2,8 | 3 | 303 012 412 |
| M 5 x 40 | M 5 | 8,5 | 40 | 16 | 3,5 | 4 | 303 012 540 |
| M 6 x 60 | M 6 | 10,0 | 60 | 18 | 4,0 | 5 | 303 012 660 |
| M 8 x 60 | M 8 | 13,0 | 60 | 22 | 5,0 | 6 | 303 012 860 |

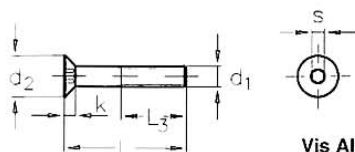

**Vis Allen tête fraisée INOX,
DIN 7991**
filetage à droite

**NIRO Countersunk bolt
with hexagon socket head acc. to DIN 7991
right hand thread**

| Désignation nominal size | d ₁ | d ₂ mm | L mm | L ₃ mm | k mm | s mm | N° article stock no. |
|-----------------------------|----------------|----------------------|---------|----------------------|---------|---------|-------------------------|
| M 4 x 10 | M 4 | 8 | 10 | - | 2,3 | 2,5 | 303 013 410 |
| M 4 x 25 | M 4 | 8 | 25 | 14 | 2,3 | 2,5 | 303 013 425 |
| M 5 x 30 | M 5 | 10 | 30 | 16 | 2,8 | 3,0 | 303 013 530 |
| M 6 x 50 | M 6 | 12 | 50 | 18 | 3,3 | 4,0 | 303 013 650 |

VIS

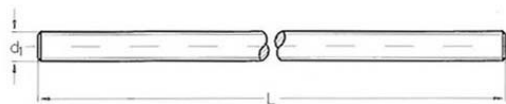

Tige filetée INOX
filetage à droite

NIRO Threaded rod
right hand thread

| Désignation nominal size | d ₁ | L mm | N° article stock no. |
|-----------------------------|----------------|---------|-------------------------|
| M 4 | M 4 | 500 | 302 040 500 |
| M 5 | M 5 | 60 | 302 050 060 |
| M 5 | M 5 | 100 | 302 050 100 |
| M 5 | M 5 | 500 | 302 050 500 |
| M 5 | M 5 | 1000 | 302 051 000 |
| M 6 | M 6 | 70 | 302 060 070 |
| M 6 | M 6 | 110 | 302 060 110 |
| M 6 | M 6 | 500 | 302 060 500 |
| M 6 | M 6 | 1000 | 302 061 000 |
| M 8 | M 8 | 80 | 302 080 080 |
| M 8 | M 8 | 120 | 302 080 120 |
| M 8 | M 8 | 500 | 302 080 500 |
| M 8 | M 8 | 1000 | 302 081 000 |
| M 10 | M 10 | 100 | 302 100 100 |
| M 10 | M 10 | 500 | 302 100 500 |
| M 10 | M 10 | 1000 | 302 101 000 |
| M 12 | M 12 | 500 | 302 120 500 |
| M 12 | M 12 | 1000 | 302 121 000 |

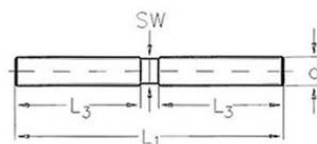

Goujon INOX
une extrémité filetée à droite, l'autre à gauche

NIRO Stud
right/left hand thread

| Désignation nominal size d ₁ | L ₁ mm | L ₃ mm | SW mm | N° article stock no. |
|-----------------------------------------------|----------------------|----------------------|----------|-------------------------|
| M 5 | 55 | 25 | 4 | 302 510 005 |
| M 6 | 65 | 30 | 5 | 302 510 006 |
| M 8 | 75 | 35 | 7 | 302 510 008 |
| M 10 | 85 | 40 | 9 | 302 510 010 |

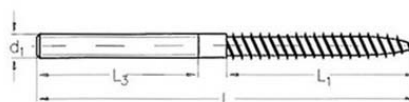

Vis à double filets INOX bois/métaux
filetage à droite ou à gauche

NIRO Wall Stud
with right and left hand thread

| Désignation nominal size d ₁ | L mm | L ₁ mm | L ₃ mm | Filetage à droite right hand thread N° article stock no. | Filetage à gauche left hand thread N° article stock no. |
|-----------------------------------------------|---------|----------------------|----------------------|-------------------------------------------------------------------|------------------------------------------------------------------|
| M 4 | 70 | 40 | 28 | 303 014 004 | - |
| M 5 | 80 | 43 | 32 | 303 014 005 | 303 015 005 |
| M 6 | 90 | 50 | 35 | 303 014 006 | 303 015 006 |
| M 8 | 130 | 65 | 55 | 303 014 008 | 303 015 008 |
| M 10 | 150 | 75 | 55 | 303 014 010 | 303 015 010 |

Sans précision, l'article ci-dessus sera livré fileté à droite.
The Wall studs are delivered with right hand thread unless specified otherwise.

M-62

S I M A

VIS

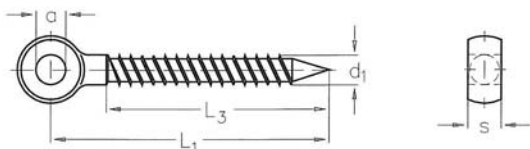

Vis à œil INOX, DIN 447
filetage bois à droite

NIRO Eye Bolt acc. to DIN 444
with wood thread, right hand

| Désignation nominal size d ₁ | L ₁ mm | L ₃ mm | a mm | s mm | N° article stock no. |
|-----------------------------------------------|----------------------|----------------------|---------|---------|-------------------------|
| 5 | 60 | 50 | 5 | 6 | 303 016 005 |
| 6 | 60 | 50 | 6 | 7 | 303 016 006 |
| 8 | 75 | 60 | 8 | 9 | 303 016 008 |
| 10 | 85 | 70 | 10 | 12 | 303 016 010 |

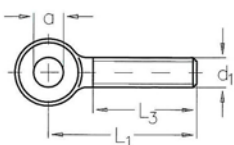

Vis à œil INOX, DIN 444
filetage métrique à droite

NIRO Eye Bolt acc. to DIN 444
with metric thread, right hand

| Désignation nominal size d ₁ | L ₁ mm | L ₃ mm | a mm | s mm | N° article stock no. |
|-----------------------------------------------|----------------------|----------------------|---------|---------|-------------------------|
| M 5 | 30 | 21 | 5 | 6 | 303 017 005 |
| M 6 | 35 | 18 | 6 | 7 | 303 017 006 |
| M 8 | 40 | 27 | 8 | 9 | 303 017 008 |
| M 10 | 50 | 31 | 10 | 12 | 303 017 010 |



Piton à œil fileté INOX
modèle long, filetage à droite

NIRO Shank Collared Eye Bolt
long type, right hand thread

| Désignation nominal size d ₁ | L mm | L ₃ mm | a mm | s mm | N° article stock no. |
|-----------------------------------------------|---------|----------------------|---------|---------|-------------------------|
| M 6 | 60 | 54 | 16 | 5 | 303 018 006 |
| M 8 | 80 | 70 | 20 | 6 | 303 018 008 |
| M 10 | 100 | 88 | 24 | 8 | 303 018 010 |
| M 12 | 100 | 88 | 30 | 10 | 303 018 012 |

Rondelle INOX, DIN 125
forme A

NIRO Washer DIN 125
Form A

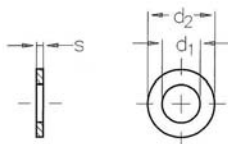

| Désignation nominal size | d ₁ mm | d ₂ mm | s mm | N° article stock no. |
|-----------------------------|----------------------|----------------------|---------|-------------------------|
| 4,3 | 4,3 | 9 | 0,8 | 303 110 004 |
| 5,3 | 5,3 | 10 | 1,0 | 303 110 005 |
| 6,4 | 6,4 | 12,5 | 1,6 | 303 110 006 |
| 8,4 | 8,4 | 17 | 1,6 | 303 110 008 |
| 10,5 | 10,5 | 21 | 2,0 | 303 110 010 |
| 13 | 13 | 24 | 2,5 | 303 110 013 |
| 17 | 17 | 30 | 3,0 | 303 110 017 |